

FOR LEASE SOLANO BUSINESS PARK
SUITES C, F and H - 17,563 (TAKE ALL OR PART)

2333 Courage Drive, Fairfield, CA

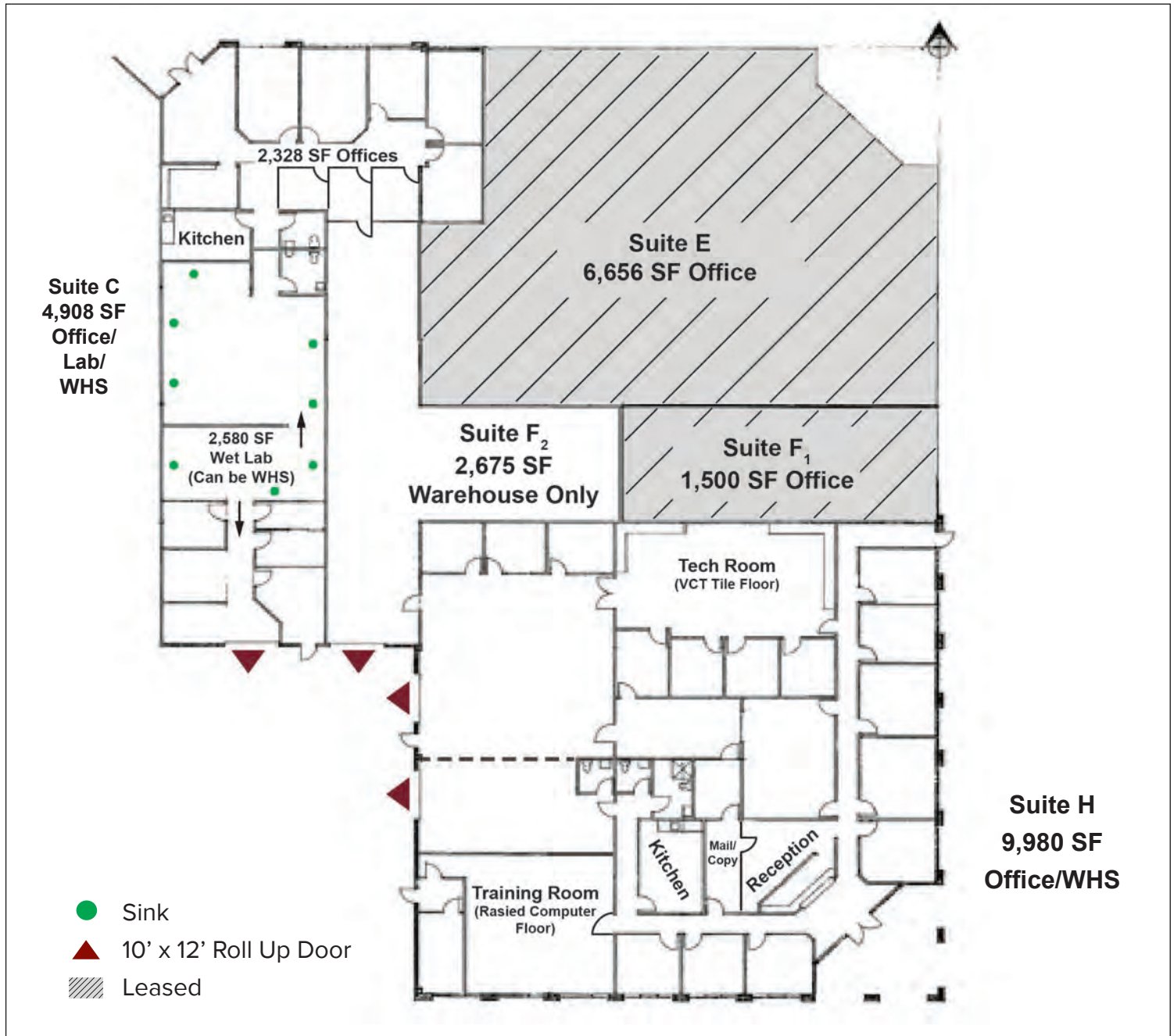

Suite C: ± 4,908 SF of finished office and highly improved wet lab. (Lab can be returned to warehouse)

Suite F: ± 2,675 SF of warehouse space.

Suite H: ± 9,980 SF of combination finished office and warehouse space.

TOTAL: ± 17,563 SF

CHRIS PETRINI

CA License No. 01020505
chris@petrinicommercial.com
Cell +1 510.507.8665

PETRINI COMMERCIAL

2333 Courage Drive, Suite H
Fairfield, CA 94534
www.petrinicommercial.com